



ARCO

Hand Coffee Grinder
USER MANUAL

This user manual applies to the GOAT STORY ARCO Hand Grinder.
Please read through this manual before using the grinder.



LEARN MORE

HELLO & WELCOME

Thank you for choosing ARCO hand coffee grinder!

ARCO makes it easy to grind coffee for any brewing method - from ibrik to cold brew - by hand and with spectacular laboratory tested grind precision. All this can only lead to one result – a stellar cup of coffee.

Before you start, take a few moments and read this brochure. It will help you get familiar with ARCO's handling and functions.

Now let's change the way you grind coffee. Forever.

IMPORTANT INFORMATION

- Read the user manual and carefully before you use the appliance for the first time. Keep it safe for later reference.
- EQUA d.o.o. (GOAT STORY) refuses all liability for loss or damage which arises as a result of failure to follow the instructions in this user manual.
- This appliance is intended to be used in household and similar applications such as staff kitchen areas in shops, offices, and other working environments, farm houses and similar and for the purposes described in the user manual. Commercial or industrial use will void the warranty.
- Unauthorized use and technical modifications to the appliance can void the warranty.
- This appliance should not be used by children. Keep the appliance out of reach of children. Children should not play with the appliance.
- This appliance can be used by persons with reduced physical, sensory, or mental capabilities or lack of experience and knowledge if they have been given supervision or instruction concerning use of the appliance in a safe way and understand the hazards involved.

ARCO HAND GRINDER

The ARCO hand grinder is a versatile high precision coffee grinder with 240 easy to adjust grind settings.

How to grind coffee with ARCO Hand Grinder:

1. Add coffee into the opening.
2. Attach the hand crank.
3. Attach the catcher/doser cup.
4. Grind by turning clockwise.

ONLY USE THE MAGNETIC CATCHER DOSER CUP TO PREVENT STATIC !

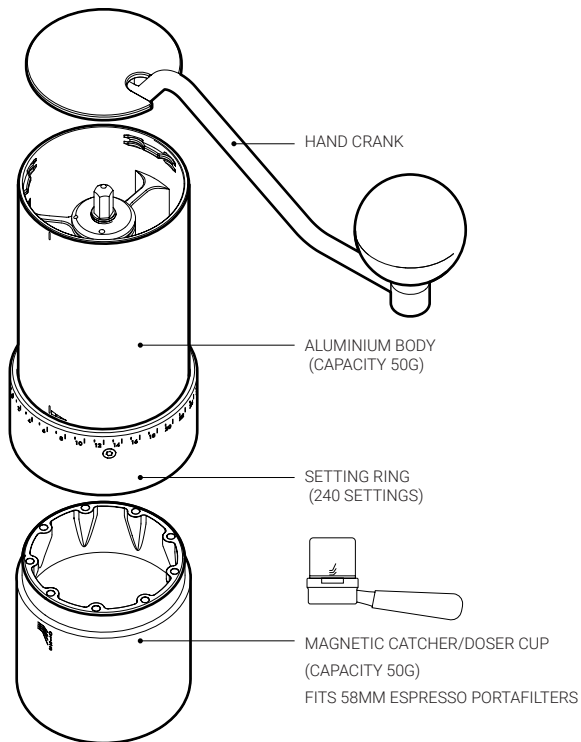

GRIND **ADJUSTMENT**

The ARCO grind adjustment system has a total of 240 grind settings that range from very fine (e.g. for ibrik) to very coarse (e.g. for cold brew). The setting system has a setting ring on the outer body of the grinder that allows for quick and accurate grind adjustment. The setting ring can be rotated by 4 full rounds with 60 settings (clicks) in each round.

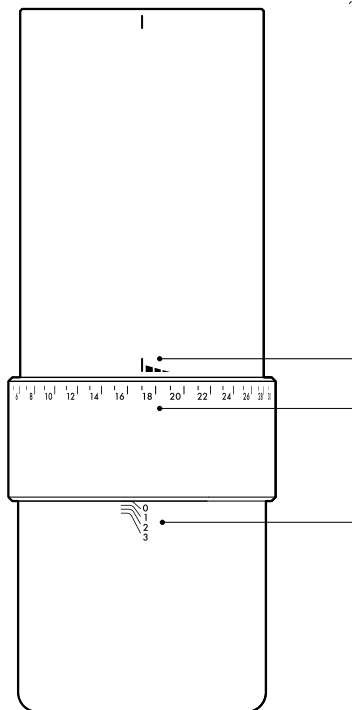

The grinder has two grind marks:

- Horizontal circular scale (indicates the number of clicks in one rotation).
- Vertical scale (indicates how many full rounds the setting ring has made).

To check the grind setting, first check the vertical scale (indicating rounds 0, 1, 2 and 3) and then the horizontal circular scale.

ZERO POINT MARK

CIRCULAR SCALE
(INDICATES THE GRIND SETTING WITH 60 CLICKS PER ROTATION)

VERTICAL SCALE
(ROUND INDICATOR)

GRIND SIZE CHART

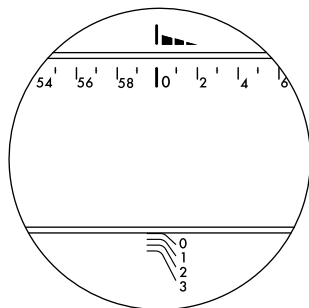

ZERO POINT

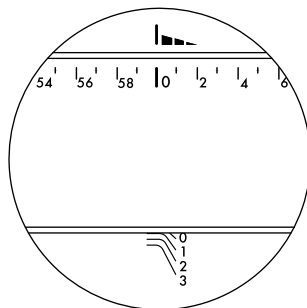

60 CLICKS

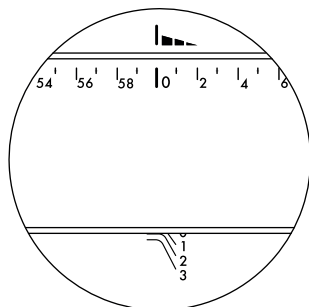

120 CLICKS

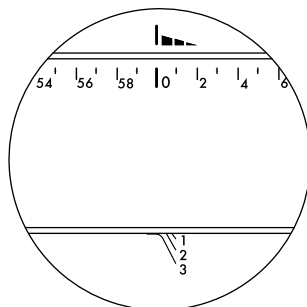

180 CLICKS

Recommended grind settings:

IBRIK
0/0-35

ESPRESSO
0/30-60

MOKA POT
1/0-40

FILTER
1/30-2/20

FRENCH PRESS
2/0-60

COLD BREW
3/0-60

REMOVING **THE BURRS**

To clean the burrs, you need to disassemble the grinder and remove the inner burr from the grinder. A special tool is needed and is included in the box.

Step 1

Insert the burr axe locker into the disassembly hole in the nut and align with the hole in the grinder body. The burr axe locker should sit at the bottom of the grinder body opening. (example A)

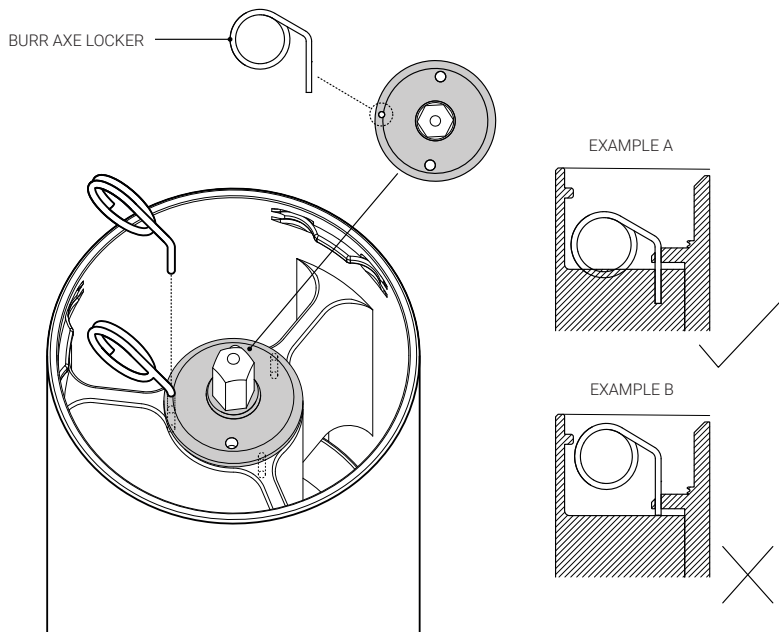

Step 2

Attach the hand crank and turn counterclockwise (to the left) until the shaft is released from the grinder body.

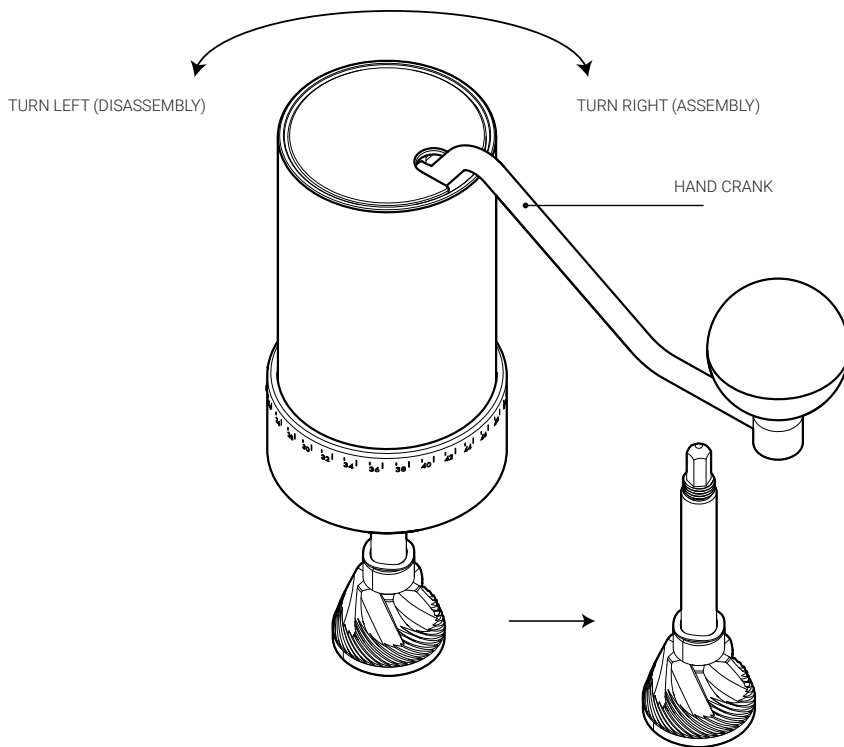

Step 3

To assemble the grinder, insert the shaft with all parts in the correct order. Turn the handle clockwise until you feel resistance. Do not overtighten!

IMPORTANT: Remove the burr axe locker after cleaning to avoid damage to the grinder!!!

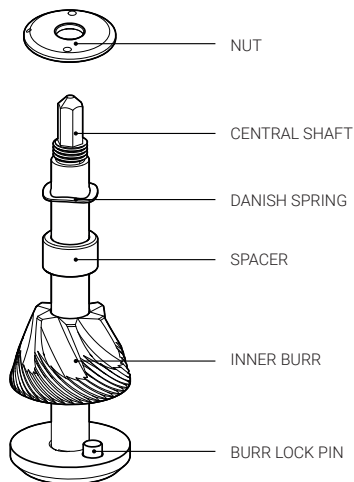

CARE & MAINTENANCE

- Do not use chemicals or cleaning substances for cleaning the grinder.
- Clean external surfaces with a damp cloth and dry well.
- Clean the burrs gently with a dry soft brush.
- Do NOT immerse the grinder in water. Do NOT wash the burrs with water.
- Wash the catcher/doser cup with warm soapy water and dry completely before use.

PRODUCT SPECIFICATIONS

Unit dimensions / mm	(H x W x D) 200 x 190 x 62 mm
Unit dimensions / Inch	(H x W x D) 7.9" x 2.4" x 7.5"
aproximate weight	800g / 1.76 Lbs
Unibody capacity	50g
Catch capacity	50g
Unibody material	Aluminum 6000/82 / powder coating finish
Catch material	Aluminum with plastic interior
Crank material	Steel with plastic knob
Conical burr	Nitrided steel 47/32mm
Catch/Doser	Compatible with 58mm portafilter

ARCO 1-year limited warranty

EQUA d.o.o. (with its trade mark GOAT STORY) issues a warranty for the product and accessories against defects in materials and manufacturing for one year from the date of purchase. The warranty does not cover wear and tear or damage caused by accident or abuse. If you submit a valid claim under this warranty, EQUA d.o.o. will either repair, replace or refund your ARCO hand coffee grinder at its own discretion. The benefits of this warranty are in addition to laws provided under local consumer laws. You may require to present proof of purchase when making a claim under this warranty.

CONTACT

web: www.goat-story.com
email: info@goat-story.com

EQUA d.o.o. / GOAT STORY
Koprska 106d,
1000 Ljubljana
Slovenia, EU

US distributor: ZIVIO LLC,
16192 Coastal Hwy,
Lewes, DE 19958, USA

Designed in EU / Made in China

WWW.GOAT-STORY.COM

